



Relief Valves

CF16/24 Series

CF-16-*10 Series

Model	Pressure Range	● Spring	Cover	Spring	Spacer	Cover Sub-Assy.
CF-16-B-10	75-1000	28860	108120	2280		925275
CF-16-BV-10		25643				925276
CF-16-BY-10		28860	108122			925277
CF-16-C-10	500-2000	28860	108120	2282		925278
CF-16-CV-10		25643	108122			925279
CF-16-CVY-10		28860	108120			925280
CF-16-F-10	1500-3000	25643	108122	2281	130735	925275
CF-16-FV-10		28860				925276
CF-16-FY-10		28860	108122			925277

298184 Screw (4 Req'd)

○ Cover (See Table)

○ 7076 Plug

○ 105680 Seat

△ 154082 "O" Ring

● Spring (See Table)

51564 Piston

18456 Seat

○ 82800 Piston

○ Spring (See table)

△ 154012 "O" Ring

○ 130728 Spacer

○ Spacer (See table)

△ 154004 "O" Ring

○ 130729 Plunger

○ 2704 Retainer

○ 130730 Adj. Screw

○ 1487 Nut

○ 124264 Knob

○ 124735 Plate

○ 114691 Screw Included in Sub-Assy 116600

136568 Plug

131234 Body

Note:
For information on Connecting Flanges refer to Drawing I-3962-S.

○ Included in Cover Sub-Assy.

▲ Included in Seal Kit 919323



CF-24-*10 Series

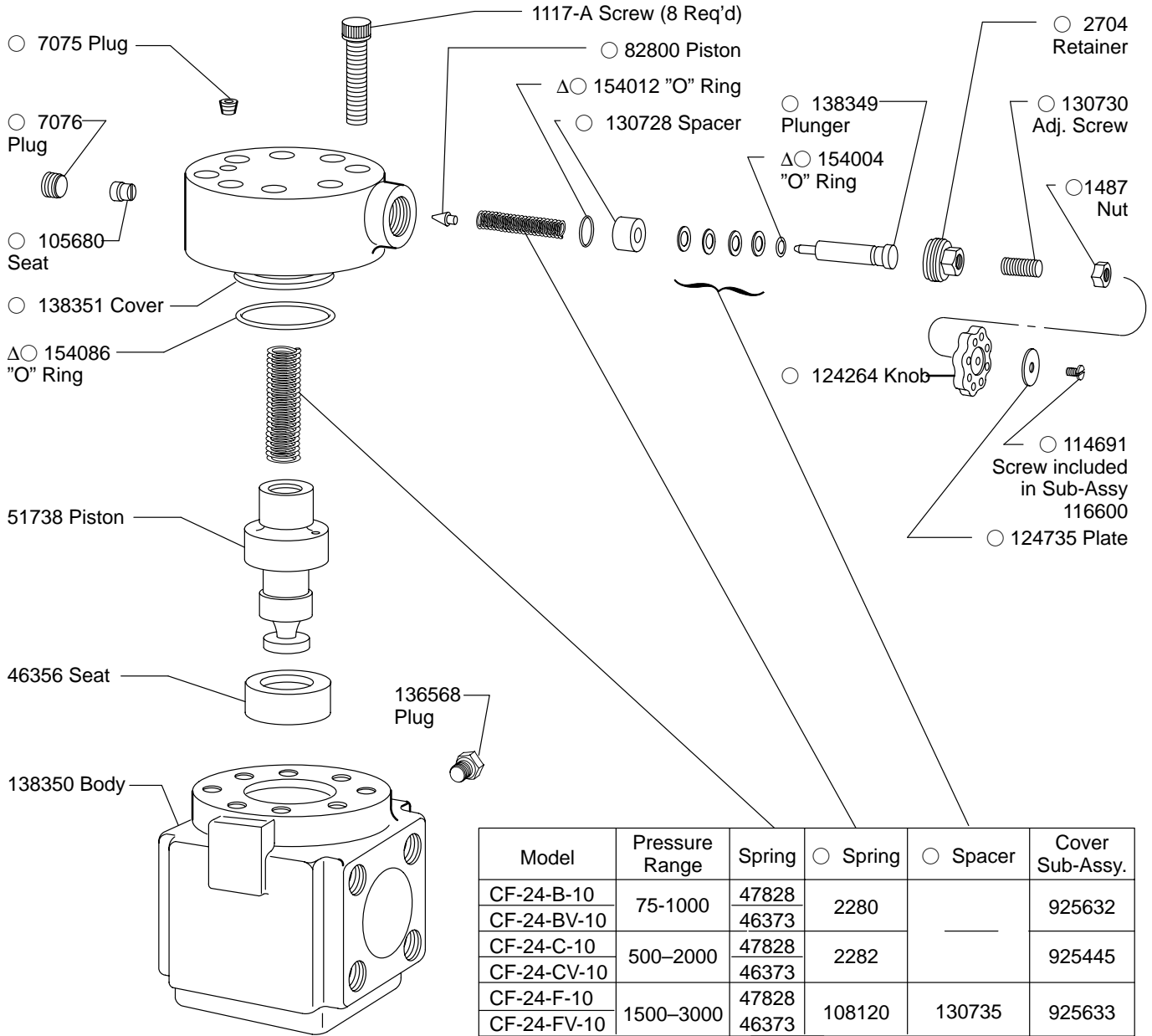

○ Included in Cover Sub-Assy.

▲ Included in Seal Kit 919323

Note:
For information on Connecting Flanges refer to Drawing I-3962-S.

For satisfactory service life of these components, use full flow filtration to provide fluid which meets ISO cleanliness code 20/18/15 or cleaner. Selections from Eaton OFP, OFR and OFRS filter series are recommended.

Printed in U.S.A.