

Pressure Relief



Pressure Relief Module

DGMC2-3-AB-*W-BA-*W-30

Model	Spring	Pressure Relief Module	Pressure Range	
			bar	(PSI)
DGMC2-3-AB-BW-BA-BW-30	531671	531708	10 - 70	145-1000
DGMC2-3-AB-CW-BA-CW-30	531672	531709	30-140	435-2000
DGMC2-3-AB-FW-BA-FW-30	531673	531710	50-250	725-3600

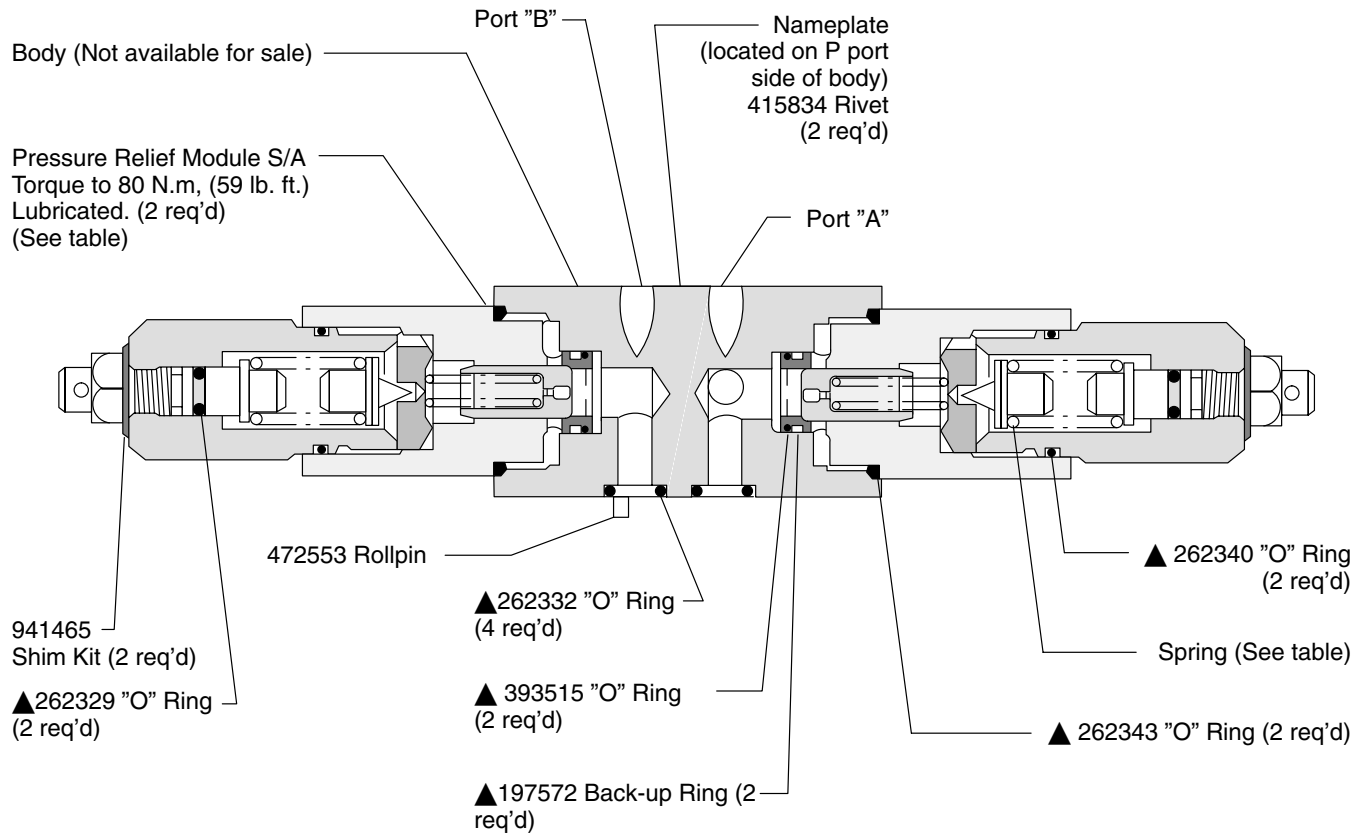

▲ Included in F3 Seal Kit 920252

Model Code

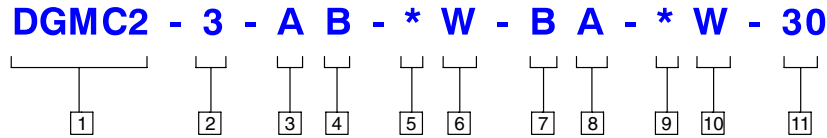

1 Model Series

DGM - Modular valves, service line relief module

2 Interface

CETOP 3 & (NFPA-D-01)

3 Port Operated Upon

A Port

4 Port Drained to

B Port

5 Pressure Controls

Adjustment Range in bars (PSIG)

Bar	PSI
B - 10-70	(145-1000 PSIG)
C - 30-140	(435-2000 PSIG)
F - 50-250	(725-3600 PSIG)

6 Adjustment Mechanism

Standard wrench adjustment

7 Port Operated Upon

B Port

8 Port Drained to

A Port

9 Pressure Controls
Adjustment Range bars (PSIG)

Bar	PSI
B - 10-70	(145-1000)
C - 30-140	(435-2000)
F - 50-250	(725-3600)

10 Adjustment Mechanism

Standard wrench adjustment

11 Design