

# Check Valves

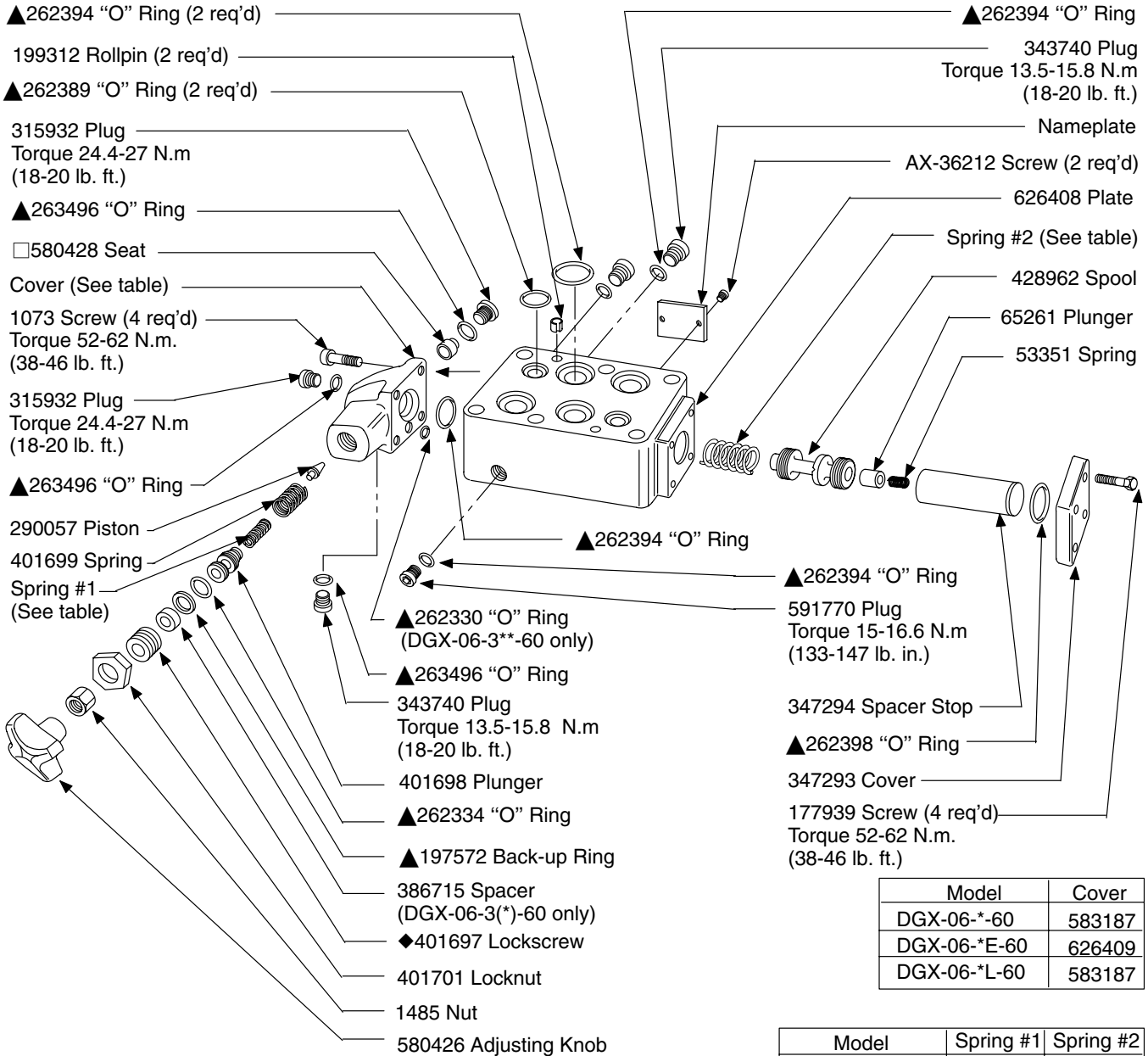

## Modular Pressure Reducing Valves

### (F3) DGX-06-\*\*(\*)-60



Model	Cover
DGX-06-*-60	583187
DGX-06-*E-60	626409
DGX-06-*L-60	583187

Model	Spring #1	Spring #2
DGX-06-1**-60	2280	—
DGX-06-2**-60	583937	
DGX-06-3**-60	401700	322653
DGX-06-*B*-60	—	
DGX-06-*F*-60	—	

**CAUTION**  

 This valve cannot be used with pressure centered valves.

◆ Assemble 401697 Lockscrew with stepped O.D. end toward 386715 Spacer or Plunger.

▲ Service all units with F3 Seal Kit 920126

**Note**  
 Assemble seat in cover with crosshole pointing in direction of arrow. Coin piston to new seat.

# Model Code

**(F3) DGX - 06 - \* \* (\*) - 60**

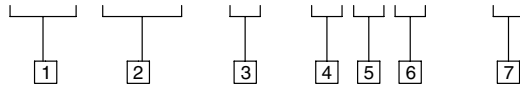

**1 Seal Material**

**F3** - Seals for mineral oil and fire resistant fluids

**4 Maximum Adjustable Pressure**

- 1 - 1000 PSI
- 2 - 2000 PSI
- 3 - 2850 PSI

**6 Flow**

- Omitted - Standard external drain to "Y" port
- E** - External drain thru cover
- L** - Internal drain to "B" port

**2 Model Series**

Directional control, subplate or manifold mounted, pressure reducing module

**5 USgpm Maximum Flow Capacity**

- B** - 06-15 80 PSI min. adj. pressure
- F** - 06-30 200 PSI min. adj. pressure

**7 Design**

**3 Port Size**

**06** - 3/4 inch

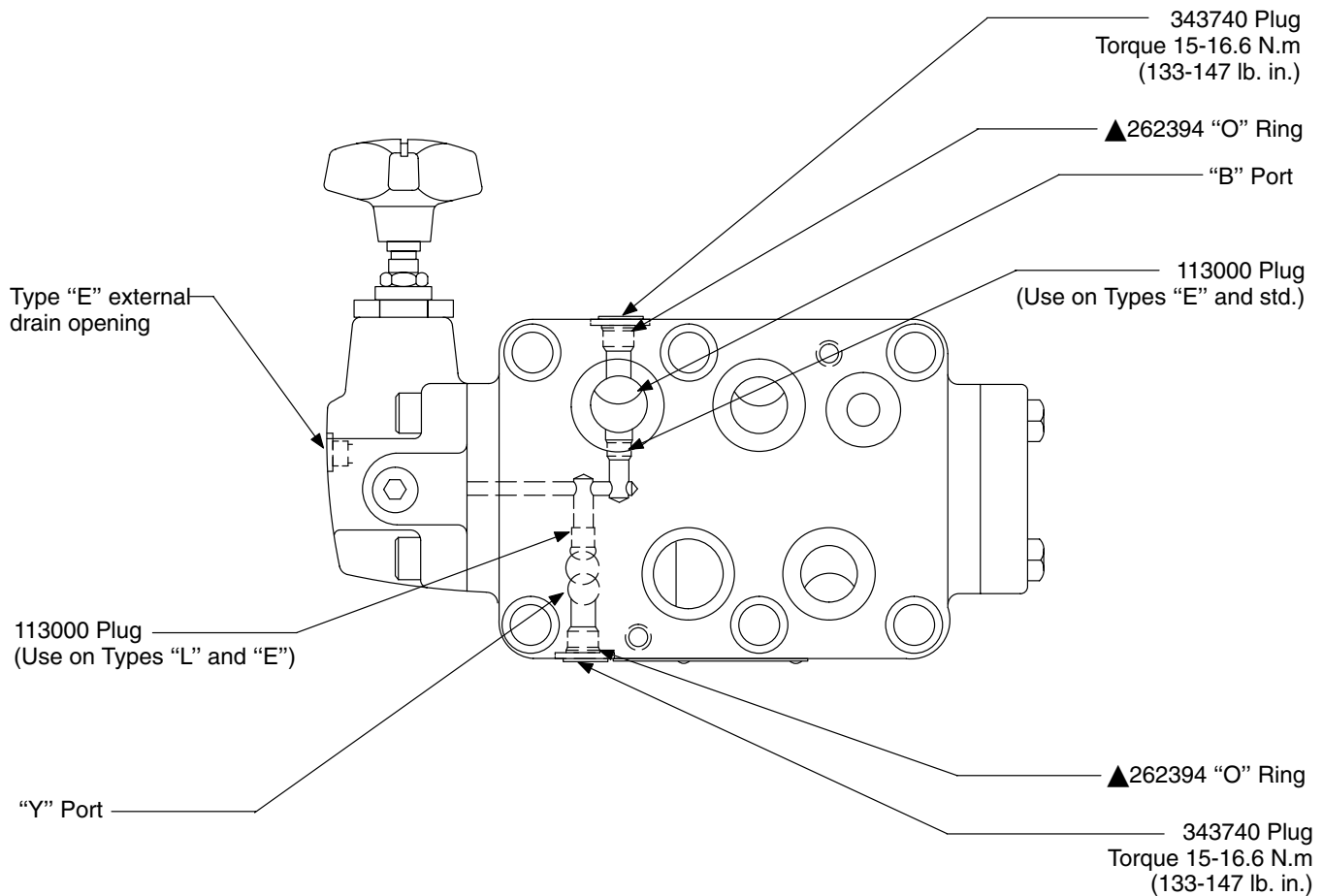

For satisfactory service life of these components, use full flow filtration to provide fluid which meets ISO cleanliness code 18/15 or cleaner. Selections from Eaton OFF, OFR and OFRS filter series are recommended.