



Multi-Pressure Relief Valves

CG-(H)-06-*(V)-(P)*DG(L)-0*-(H)*-20

CG-(H)-10-*(V)-(P)*DG(L)-0*-(H)*-20

Model	Head #1		Head #3		●CG-(H)06 Cover S/A	●CG-(H)10 Cover S/A
	Spring	Pressure Range PSI	Spring	Pressure Range PSI		
CG-(H)06/(H)10-BC	2280	125-1000	583937	500 - 2000	942155	942156
CG-(H)06/(H)10-BF			2281	1500 - 3000	—	—
CG-(H)06/(H)10-CF	583937	500-2000	—	—	—	—

●Included in cover subassembly

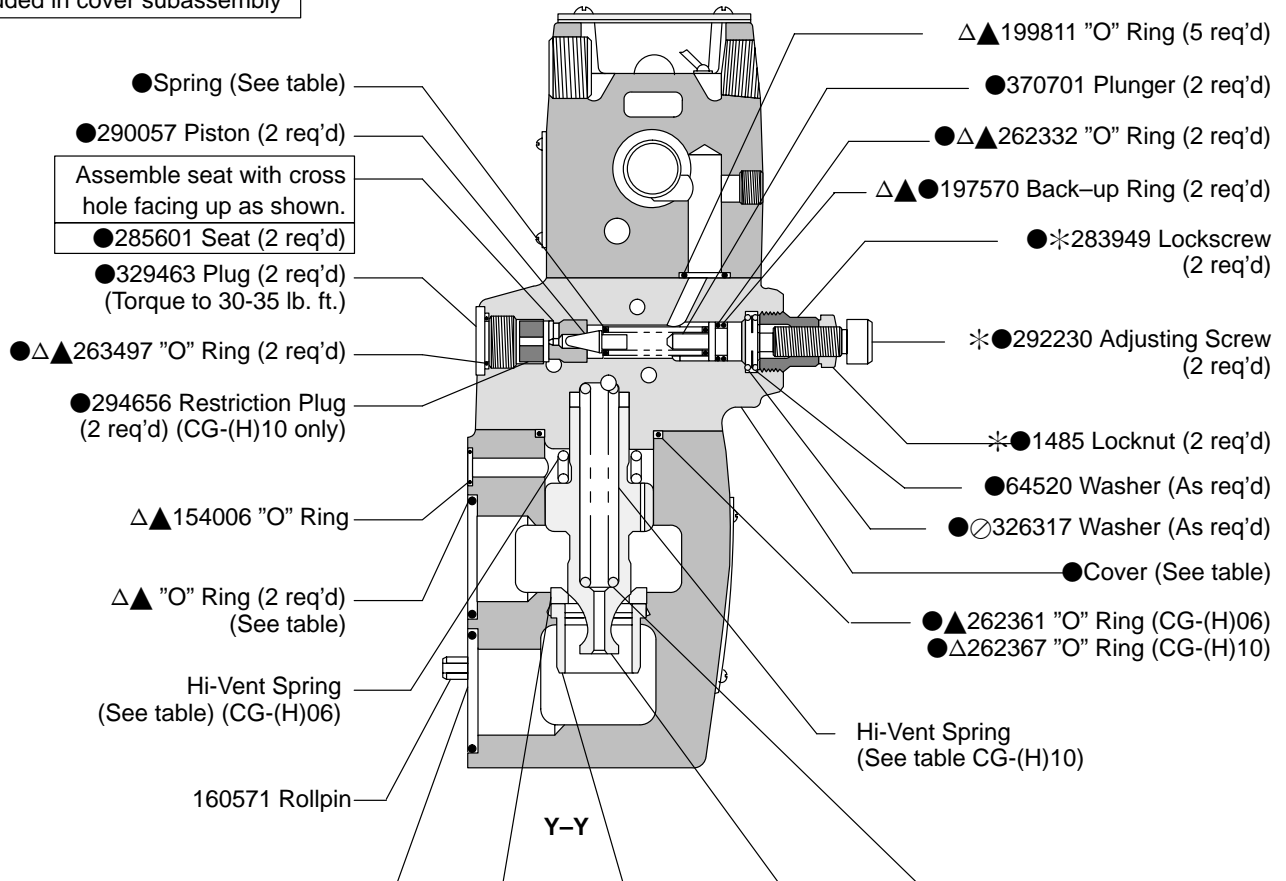

Model	"O" Ring (2 req'd)	Body	Seat	Sleeve	Hydro Cone	Lo-Vent Spring	Hi-Vent Spring	Cover
CG-06	▲154020	580456	343153	—	343154	2077	184458	370666
CG-H06			589473	589472				
CG-10	Δ154024	581703	283954	—	283952	291822	291821	370671
CG-H10			587996	400730				

All seals, except directional valve & relief valve interface seals, are F3. Use F3 seal kit to service all units.

Use either a Lo-Vent or Hi-Vent spring as shown. Do not use both.

Included in F3CG-(H)06 Seal Kit 919684

Included in F3CG-(H)10 Seal Kit 919685

⊘ This part used at final test to obtain correct pressure range.

***Note**
Coat 292230 Adjusting Screw, 283949 Lock Screw and 1485 Locknut with oil prior to assembly.

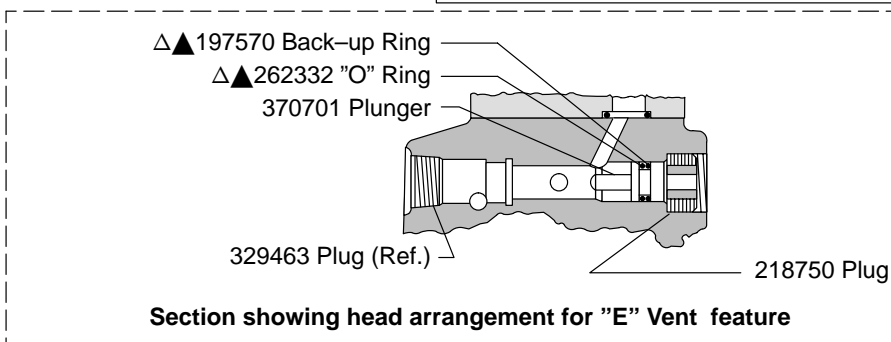

DG4S4-010N-*-51 Pilot Valve
(Refer to I-3471-S for parts information)

DG4S4-010A-*-50 Pilot Valve
(Refer to I-3478-S for parts information)

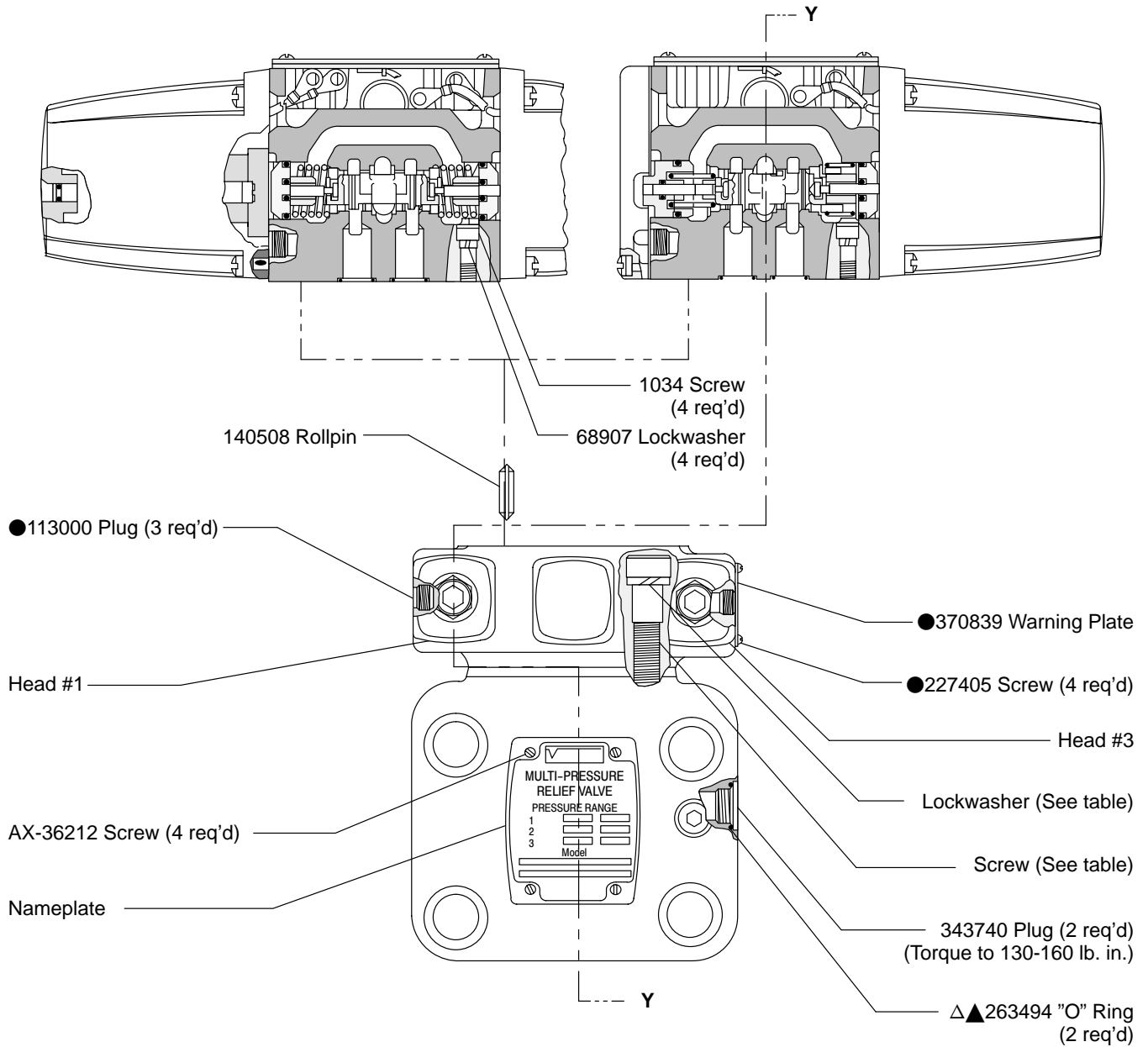

Model	Screw (4 req'd)	Lockwasher (4 req'd)
CG-(H)06	1036	68907
CG-(H)10	1076	68909



WARNING

Do not use other than a DG4S4-010A-*-50 or a DG4S4-010N-*-51 directional valve as the pilot for this relief valve. Use of a different pilot can block the relief valve, causing excessive system pressure.

Insta-plug connectors for the DG4S4 pilot stage are shown on parts drawing I-3487-S.

Model Code

(F3) - C * - (H) ** - * (V) - (P) (*) D G (L) - (8) C - (H) - (*) - 20

1 2 3 4 5 6 7 8 9 10 11 12 13 14 15 16 17

1 Seal Material

F3 - Seals for mineral oil and fire resistant fluids

2 Model Series

CG - Relief valve, manifold or subplate mounted

3 Flow Type

H - High flow

4 Nominal Size

06 - 3/4"
10 - 1 1/4"

5 Pressure Range PSI (For heads #1 or #3)

B - 125 - 1000
C - 500 - 2000
F - 1500 - 3000
E - Vent

6 Vent Spring

V - High vent spring
Omitted - Low vent spring

7 Insta Plug Type

P - Insta Plug feature
Omitted - Not required

8 Plug Type

A - With plug only
B - With plug and receptacle
Omitted - Not required

9 Valve Type

D - Directional valve pilot stage

10 Mount Type

G - Manifold or subplate mounted

11 Solenoid Light Type

L - Solenoid indicator light
Omitted - Without lights

12 Spool Type

O - Open centered spool

13 Pilot Valve Type

N - No spring detent pilot stage
A - Offset pilot stage

14 Solenoid Type

H - Oil immersed solenoid
Omitted - Standard solenoid

15 Solenoid Voltage

Omitted - Standard solenoid 115 AC 60

16 Design

For satisfactory service life of these components in industrial applications, use full flow filtration to provide fluid which meets ISO cleanliness code 18/15 or cleaner. Selections from Eaton OFF, OFR, and OFRS series are recommended.