

Heavy Duty Piston Pump

PVE62*-3-10-C**-13

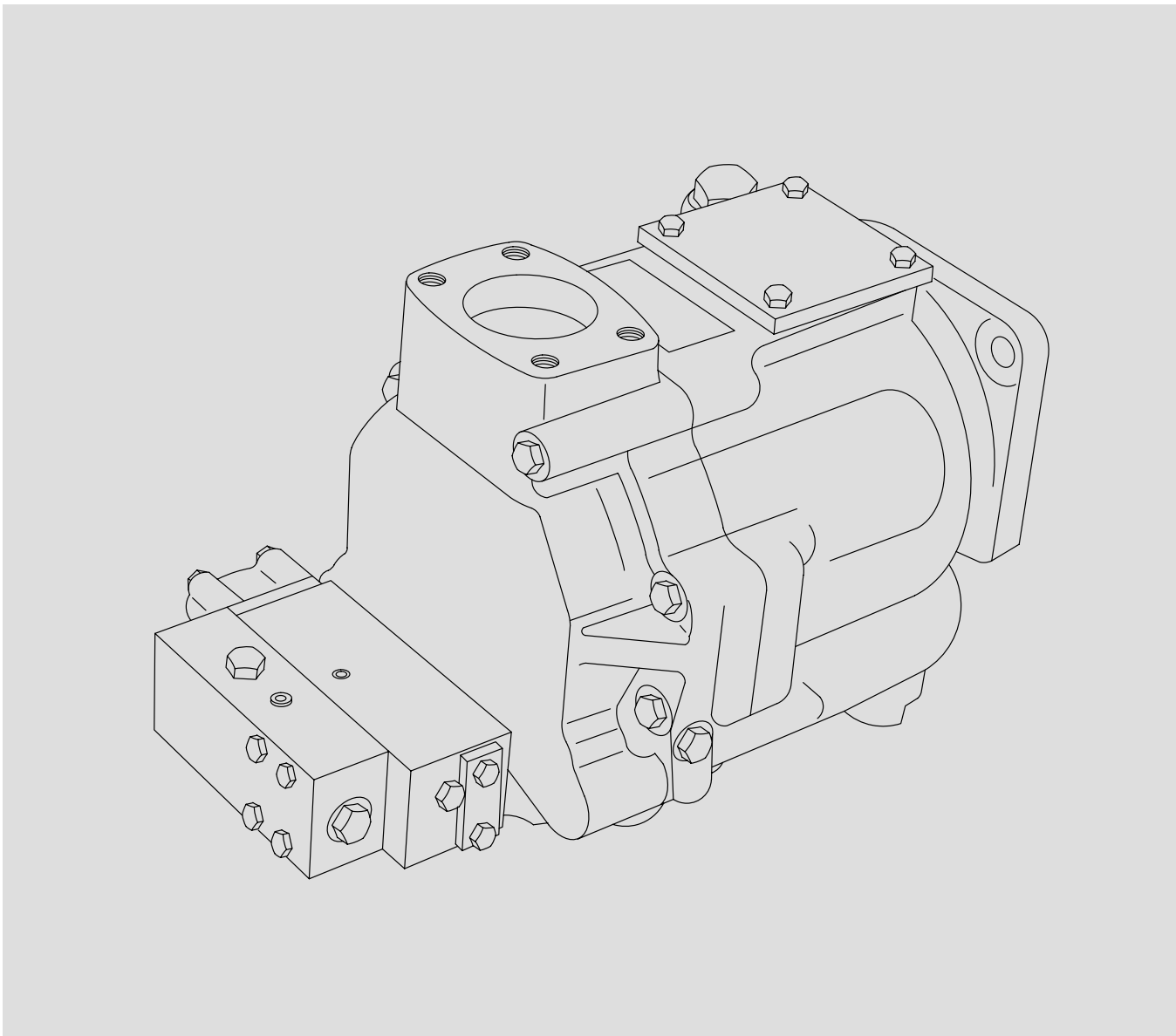

Note
 Controls are shown as installed for L.H. rotation. For R.H. rotation, controls are rotated 180°.

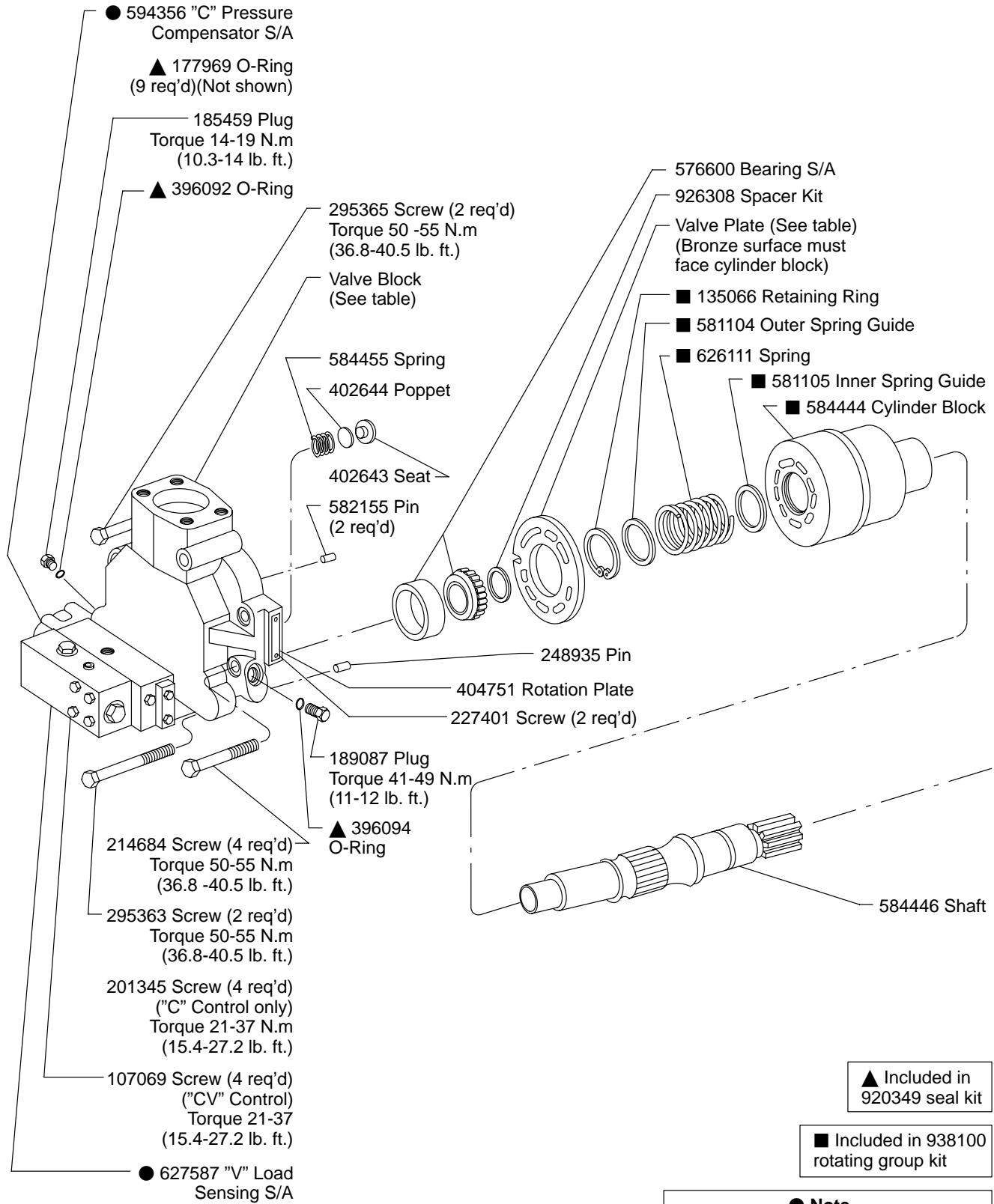

▲ Included in 920349 seal kit

■ Included in 938100 rotating group kit

Model	Valve Block	Valve Plate	Shaft Rotation
PVE62L	597458	581108	CCW Left
PVE62R	597460	597465	CW Right

Note
 Exploded views of 'C' and 'CV' controls are shown on back page for reference only. Controls must be ordered as a complete S/A.

PVE62*-E3-10-C(V)-13

*** Note**

Parts are shown for left hand shaft rotation. The position of control and bias pistons are reversed for right hand rotation. (Assemble using Loctite 270)

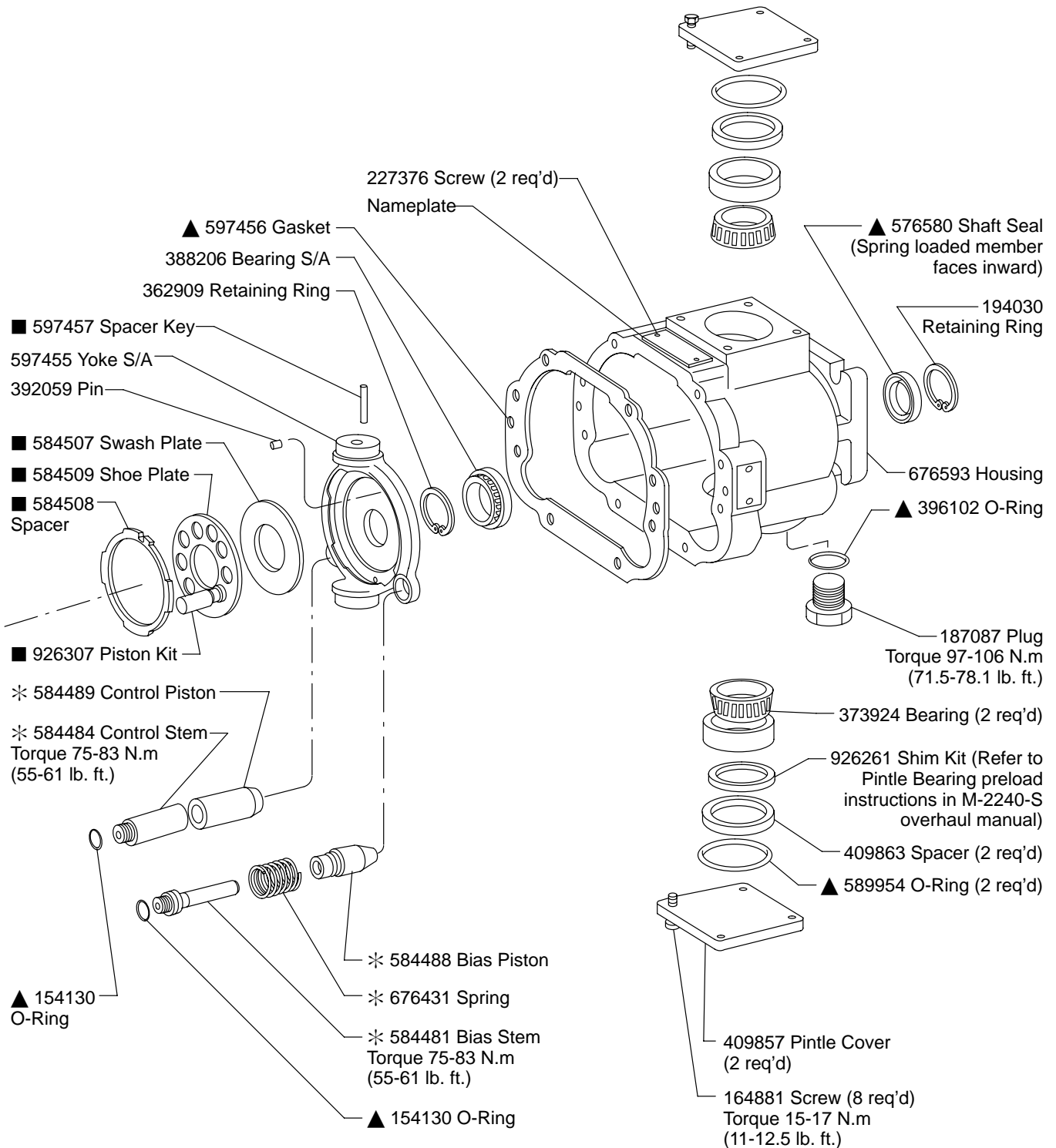

Model Code

PVE 62 * - 3 - 10 - C* - 13

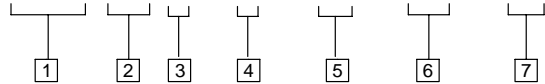

1 Model Series

PVE - Pump, variable, inline series E

2 Flow Rating in USgpm (at 1800 RPM)

62 - 62 USgpm

3 Shaft Rotation (Viewed from Shaft End)

R - Right hand (CW)
L - Left hand (CCW)

4 Input Shaft

5 Pump Design

6 Control Type

C - Pressure compensator
CV - Load sensing with pressure limiter

7 Control Design

'C' Pressure Compensator Control

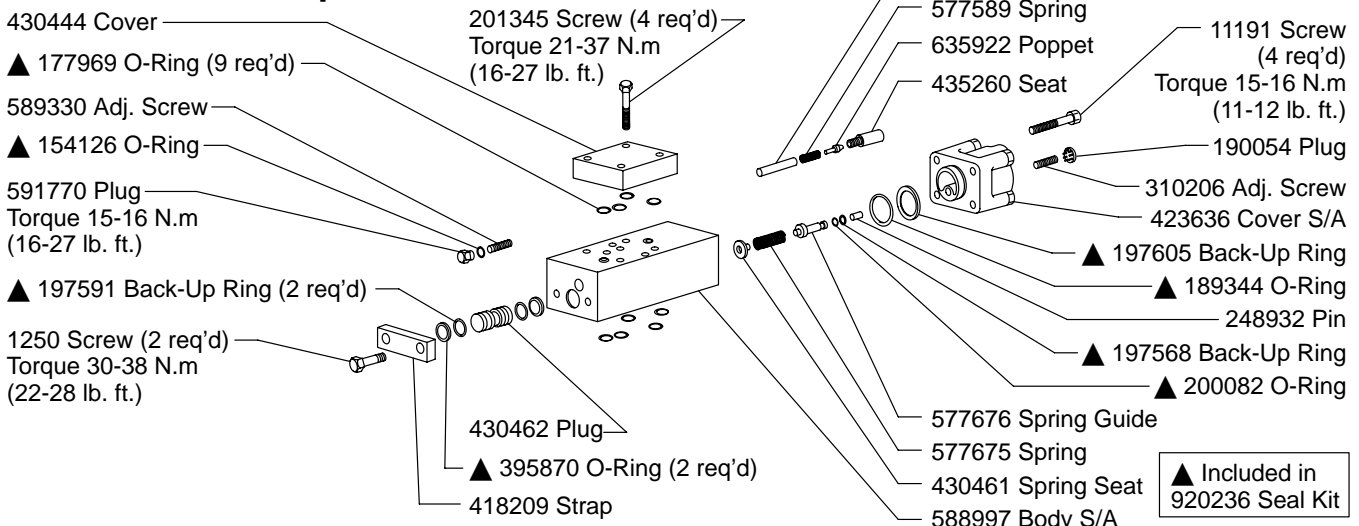

'CV' Load Sensing Control

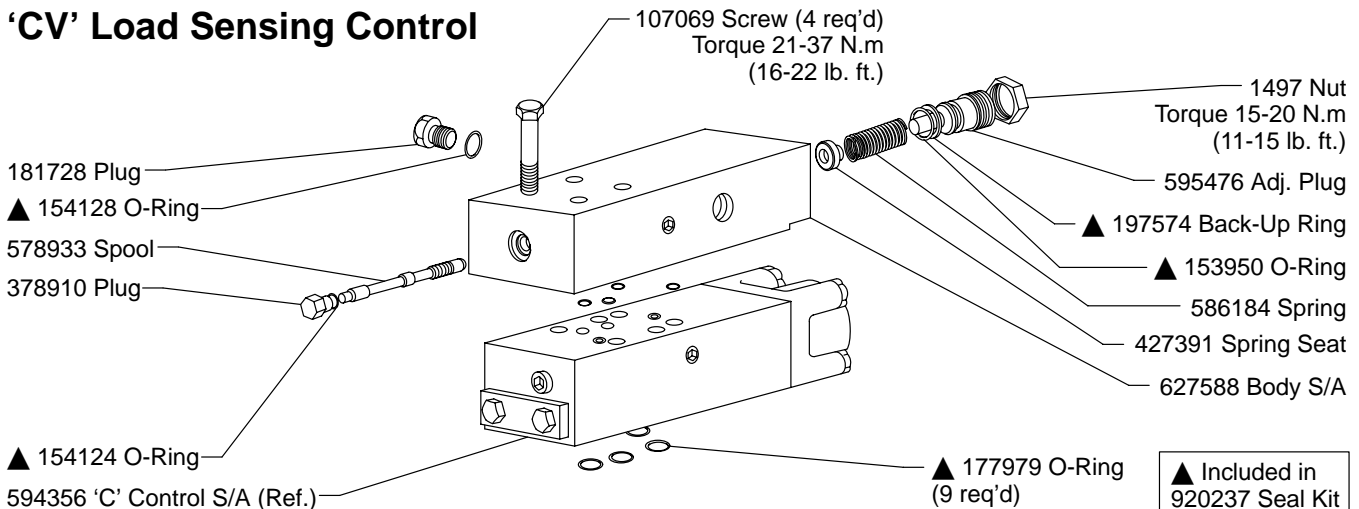

For satisfactory service life of these components, use full flow filtration to provide fluid which meets ISO cleanliness code 20/18/15 or cleaner. Selections from Eaton OFF, OFR and OFRS filter series are recommended.